

Instruction

EVSI (EV220B)

Normally Closed/ Normally open (NC/NO)



Types

Type EVSI (EV220B) 6, 10, 12, 18 and 22 Normally Closed (NC)
 Type EVSI (EV220B) 6 and 10 Normally Open (NO)

Coils

Coils	Code no.	
	Junction Box	Conduit hub
24 V ac, 50 / 60 Hz	018F7683	018F7693
110 V ac, 50 / 60 Hz	018F7682	018F7692
120 V ac, 60 Hz		
208 - 240 V ac, 60 Hz	018F7681	018F7691
230 V ac, 50Hz		

Max. ambient temperature 122°F (50°C)

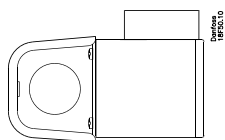

Junction box

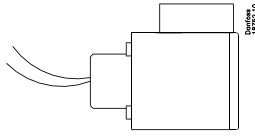

Conduit hub

Coil replacement

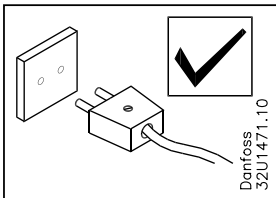

1. Before removing the coil, voltage must be disconnected, otherwise the coil will burn out

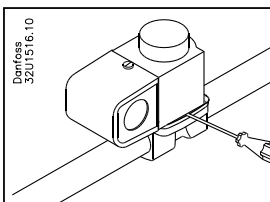

2. Use a screwdriver to lever the coil from the armature.

Media temperature

Gasket materials	Media	Temperature
EPDM	Water / Steam	14°F → 194°F
FKM	Oil / Inert gas incl air	14°F → 194°F

Mounting the valve

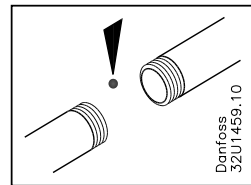

1. Clean the pipe system before mounting the valve

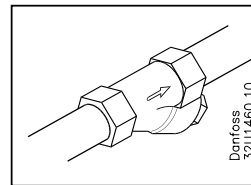

2. Mount filter in front of the valve if there are impurities in media

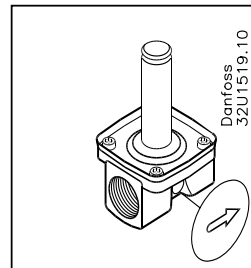

3. The arrow cast on the body must point in the direction of the flow

4. Mount the valve as shown in the pictures. The valve can be mounted with a max. angle of 90° from upright position.

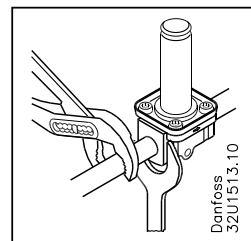
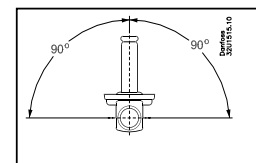
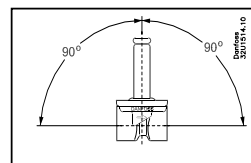

5. Use counterforce when tightening up pipe connections, i.e. use a spanner on both the valve body as well as on the pipe connector.

To be continued on page 2

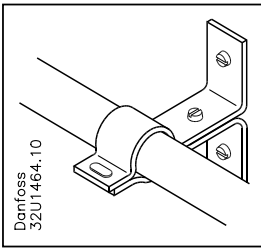

6. The pipes on both sides of the valve must be securely fastened.

**! Test pressure
MAX. 725psi
(50 bar)**

Warning

7. Test the system
Maximum pressure for
EVSI 6 - 10 (EV220B 6 - 10):
725 psi (50bar).
**EVSI 12 - 22 (EV220B 12 - 22):
232 psi (16 bar)**

Mounting the coil

Note 1. **Warning**
Never switch on power to the coil when the coil is dismantled from the valve. Otherwise the coil may be damaged and there is risk of injuries and burns.

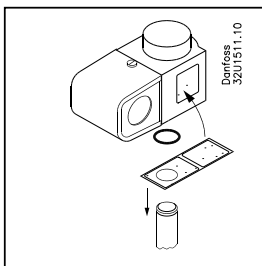

2. Mount the label on the coil and put the armature tube label over the tube.

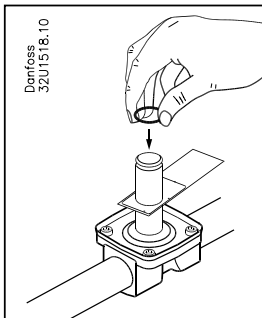

3. Mount the O-ring.

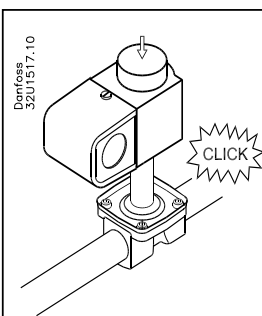

4. Mount the coil on the valve. The coil must **CLICK** in order to be positioned correctly.

Safe working pressure

Types	Pressure
EVSI (EV220B) 6 and 10 (NC/NO)	350 psi (25 bar)
EVSI (EV220B) 12, 18 and 22 (NC)	142 psi (10 bar)

Differential pressure

Types	Pressure	
	Min.	Max.
EVSI (EV220B) 6 (NC/NO)	2 psi (0.1 bar)	142 psi (10 bar)
EVSI (EV220B) 10 (NC/NO)	2 psi (0.1 bar)	142 psi (10 bar)
EVSI (EV220B) 12, 18, 22 (NC)	4 psi (0.3 bar)	142 psi (10 bar)

Spare parts kit

Normally closed valves (NC)

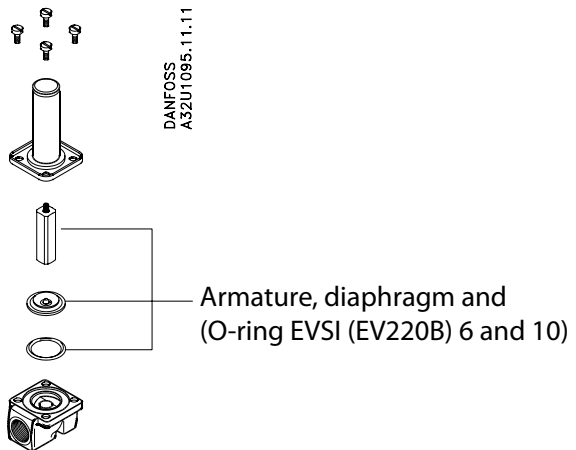

Types	Media	Code no.
EVSI (EV220B) 6	W	032U1062
EVSI (EV220B) 6	OL	032U1063
EVSI (EV220B) 10	W	032U1065
EVSI (EV220B) 10	OL	032U1066
EVSI (EV220B) 12	W	032U1068
EVSI (EV220B) 12	OL	032U1067
EVSI (EV220B) 18 and 22	W	032U1070
EVSI (EV220B) 18 and 22	OL	032U1069

Spare parts kit

Normally open valves (NO)

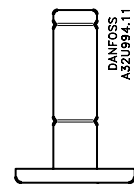

Types	Media	Code no.
EVSI (EV220B) 6	W	032U0165
EVSI (EV220B) 10	OL	032U0167